

ASSEMBLY INSTRUCTIONS CORNER SHOP/PUB

GENERAL GUIDELINES

These assembly instructions follow the procedures we use in our workshop.

You will find that assembly is easier when working on a smooth flat surface.

Ensure sufficient protection is used to prevent damage to the work surface especially when drilling.

Standard white PVA glue is suitable for all joints. Follow the manufacturer's recommendations on application and handling.

WE DO NOT RECOMMEND THE USE OF FAST DRYING GLUE

We do not use nails or screws for the carcass assembly.

The carcass is held together with parcel tape until the glue is fully dry.

These kits are very accurately made and it is important to ensure all joints are pushed fully home.

We strongly recommend that you first put the assembly together, without glue, to familiarize yourself with the procedure and ensure that all the parts are fitted correctly.

THIS KIT CAN BE PUT TOGETHER FOR A LEFT OR RIGHT HAND BUILDING SO YOU NEED TO

Clamping the carcass with sash cramps, 'G' cramps etc. may pull it out of square, as will standing it on an uneven surface.

You do need to have a flat surface to assemble this kit on.

Main carcass components decide which hand you would like your shop/pub to be and lay the components down to suit. The instructions will follow the assembly for the left hand opening.

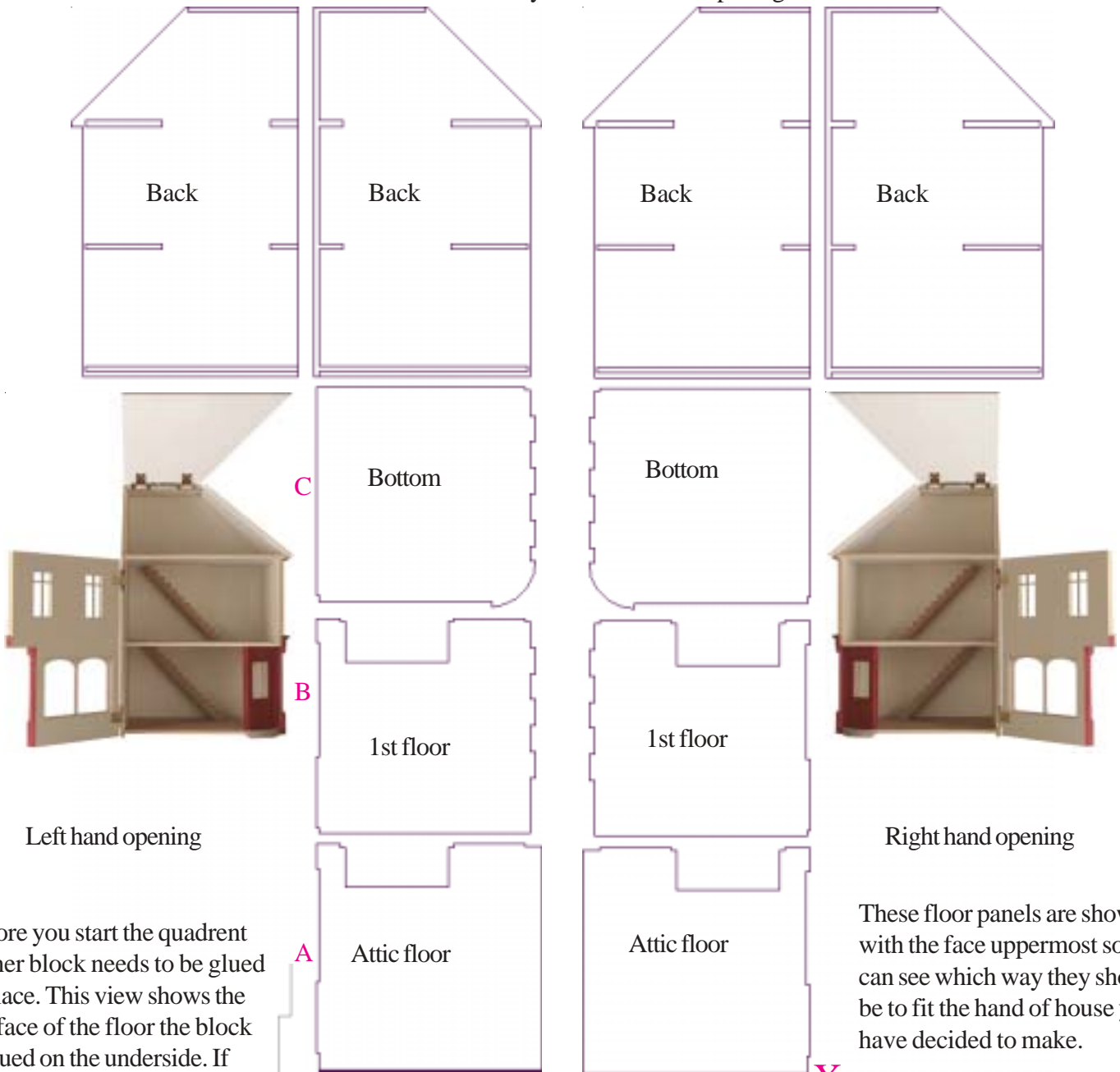

Left hand opening

Right hand opening

Before you start the quadrant corner block needs to be glued in place. This view shows the top face of the floor the block is glued on the underside. If you are unsure do the dry run and check when you stand the house upright.



These floor panels are shown with the face uppermost so you can see which way they should be to fit the hand of house you have decided to make.

Turn the back panels over and push the edges together make sure they line up at **X** Put parcel tape across the panels as shown This will act as a hinge during assembly and hold the carcass together while the glue dries. Next turn the back panels over from top to bottom so the grooves are uppermost. Fit the bottom first floor and attic floor in place position edges marked **AB** **C** in the grooves marked. Lift the other panel up the parcel tape will act as a hinge to keep the corner together.

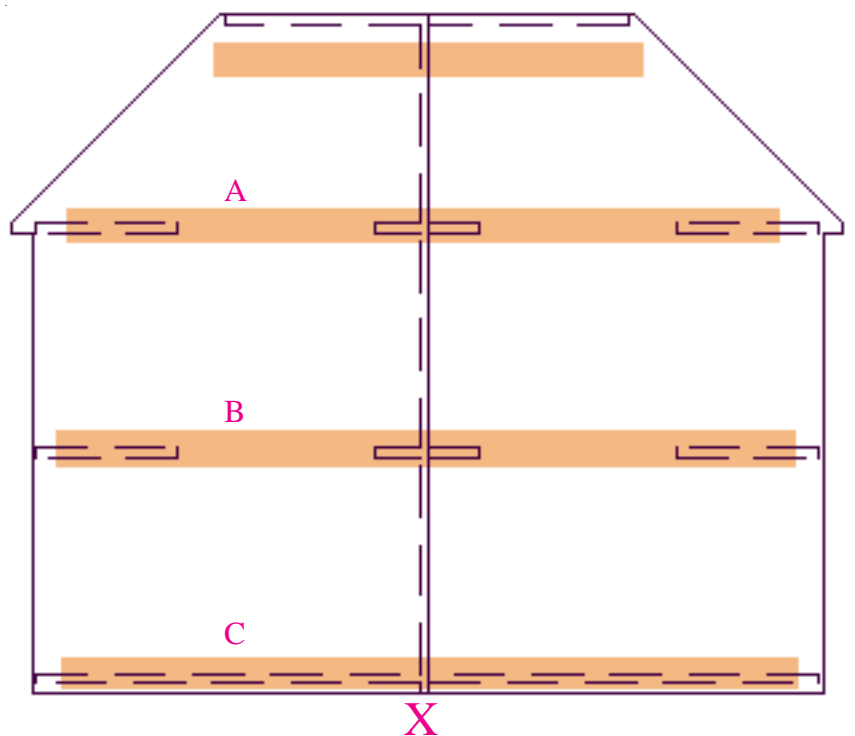

Stand the house up and put parcel tape on as shown. Stick the tape firmly on the edge top and bottom of the floor and pull tight around and onto the back panel. do this to all three floors. Make sure all floors are pushed right back into the grooves before leaving it for the glue to dry.



Next glue the fixed side in place. Lay the house on its side so the fixed side can be positioned. Make sure it lines up flush with the back panel along the edge **Y**. Measure the overhang of the attic floor at **Z**. Make sure it is the same overhang at the front edge **F**. Put parcel tape on as shown to hold the joints together till the glue has dried.

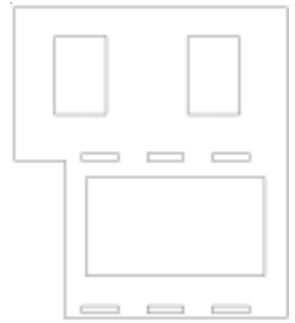

Now the roof can be fitted. The first thing is to identify the top roof panel there are two one of each hand use the correct one and throw the other away. The one shown on the left is the correct one for left hand opening. Turn this over locate the hinges in the notches and screw into position.

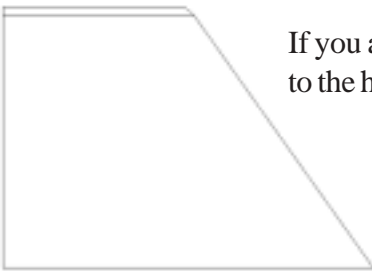

If you are not sure about it offer the two pieces up to the house before screwing them together.

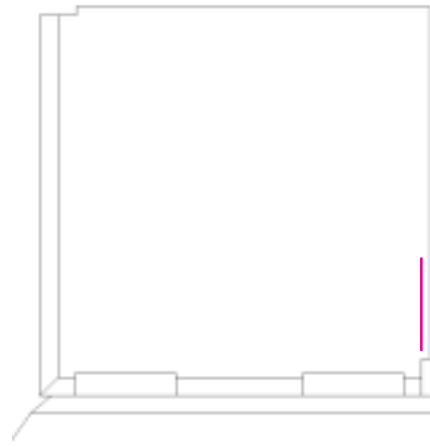

9.2mm step or the thickness of the mdf

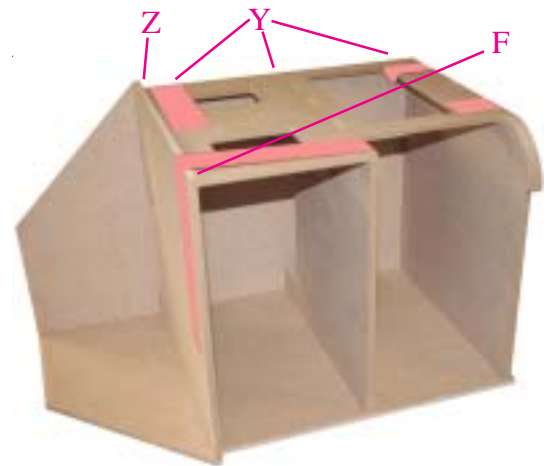

Now glue this part of the roof on using parcel tape to hold it in position make sure the glue is dry before progressing. To fit the fixed part of the roof line it up with the hip and top of the roof edge. The overhang at the eaves does not need to be exact neither does the back edge of the roof but the hip and top edge will show if not lined up properly.

Now to fit the detail on the doors start by gluing on in the following order. Start with the opening door and double check which hand it needs to be or the trim will be stuck on the wrong side. The first thing to do is to push the magnet through to the inside face of the door and then glue it in place from the back of the hole.

1. main column piece on next to the corner door.
2. shop facade.
3. outer main column.
4. sign board.
5. quoins.
6. bottom blocks.
7. the two top block pieces together.
8. the window surrounds and cills

The trim for the fixed side is fitted in the same order but the sign trim and quoin overhang the edge. Make the sign board flush at **X**. The quoin should overhang 9.2mm. It may be best to fit the quoin strip after the opening door has been hinged and then you will see just where to glue it.

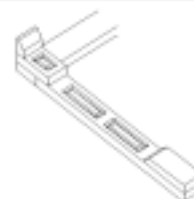
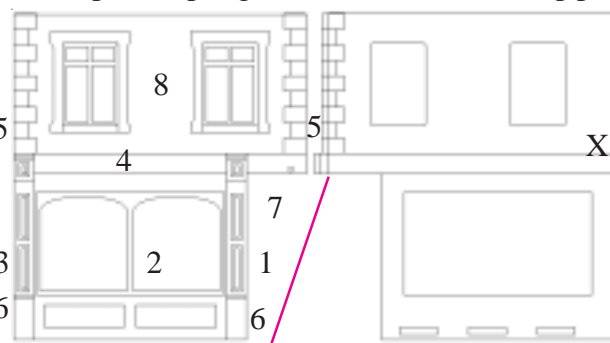

The small door can now be hinged into its frame the hinges are laid flat on the face and screwed in place. the frame is then positioned diagonally across the door way. It is glued to the roof floor and the fixed side.